

TRUE LOCK Distal Femur Lateral Anatomic Plates are indicated for fixation of fractures of the distal femur. Like; Distal diaphyseal fracture, intra-articular fracture, supracondylar periprosthetic fracture.

Distal femur fractures' rate is 37/100.000 of all fracture types, %4-%6 of all femoral fractures. Due to the age distribution; it increases in two different terms. First term consists of young patient with traffic accident or falling from high with high energy trauma with partial fractures, second term consists of osteoporotic old patients with falling down with low energy trauma and with commonly spiral oblique and less partial fractures.

Anatomical plate; right & left
10 hole options between 3-21.

TRUE LOCK Distal Femur Lateral Anatomic Plates are made of Ti6Al4V ELI material (ASTM F136).



TRUE LOCK Distal Femur Lateral Anatomic Plate Features

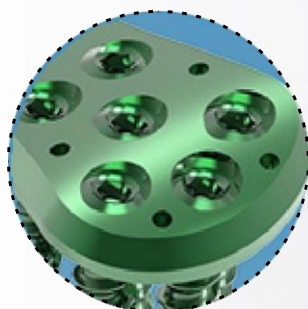

Kirschner wire holes accept Kirschner wires (up to 2.0 mm) to temporarily fix the plate to the tibia, to temporarily reduce articular fragments, and to confirm the location of the plate, relative to the tibia.



Elongated Combi holes on shaft facilitate plate adjustment and allow locking or compression options

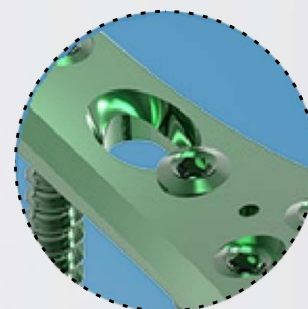

Less invasive surgery with carbon guide

Optimized screw position in the condyles to avoid intercondylar notch and patellofemoral joint and maximize bone purchase.

TRUE LOCK Distal Femur Lateral Anatomic Plate Screws Info

Reference Number:	Hole Count:	Length (mm)
(L) 201-11051-003 (R) 201-11052-003	3 hole	105
(L) 201-11051-005 (R) 201-11052-005	5 hole	140
(L) 201-11051-007 (R) 201-11052-007	7 hole	175
(L) 201-11051-009 (R) 201-11052-009	9 hole	210
(L) 201-11051-011 (R) 201-11052-011	11 hole	245
(L) 201-11051-013 (R) 201-11052-013	13 hole	280
(L) 201-11051-015 (R) 201-11052-015	15 hole	315
(L) 201-11051-017 (R) 201-11052-017	17 hole	350
(L) 201-11051-019 (R) 201-11052-019	19 hole	385
(L) 201-11051-021 (R) 201-11052-021	21 hole	420

4.5 mm Non-Locking Cortical Screw



4.5 mm Locking Cortical Screw



4,5 mm Locking Cannulated Cortical Screw



6,5 mm Non-Locking Cancellous Screw



6,5 mm Locking Cancellous Screw



6,5 mm Non-Locking Cannulated Cancellous Screw



6,5 mm Locking Cannulated Cancellous Screw

